



Typ / Type: DV 400-G.5FA		Art.-Nr. / Art.-No.: A05-40020	
U	400V (50Hz)	Δp_{fa} min	-- Pa
P ₁	0.85 kW	ΔI	-- %
I _N	1.70 A	I _A / I _N	2.0
n	1700 min ⁻¹		IP44
C _{400V}	-- μ F		01.390 b)
t _R	45 °C		29 kg



LWA _{rel} A-bewertet bei V=0,5*V _{max} LWA _{rel} A-weighted at V=0,5*V _{max}		fM [Hz]						
		125	250	500	1K	2K	4K	8K
LWA ₅ [dB(A)]	Ansaugseite / inlet side	-18	-13	-12	-9	-7	-14	-21
LWA ₆ [dB(A)]	Ausblasseite / outlet side	-16	-10	-6	-5	-6	-13	-22

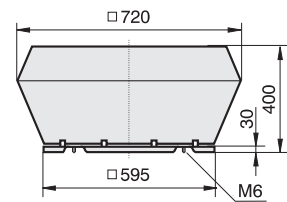
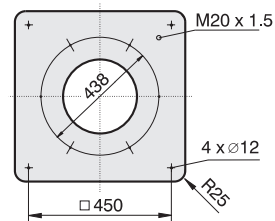

01.390

Betriebsart / Operation mode
a) Steuerbetrieb / open-loop control

Betriebsart / Operation mode
b) Regelbetrieb / closed-loop control